

Type	Job. Ref.
------	-----------



4BLRD

4" LED
Recessed Downlight

1200 - 5500 Lumens

PRODUCT SPECIFICATION DATA

MECHANICAL

Precision formed 16 ga. galvanized steel ceiling pan with built-in plaster ring
Accommodates up to 3/4" ceiling thickness
Bar hangers accommodate 27" span
Accessible ceiling only

ELECTRICAL

Serviceable and upgradable light engine.
Power supply is overload and short circuit protected
See Lumens Column for standard dimming

OPTICAL

Self-flanged lower reflector
45° cutoff to source
Medium distribution

PERFORMANCE

CCT: 3000K; 3500K; 4000K @ 80+ CRI
70% lumen maintenance at 50,000 hours based on IESNA LM-80-2008.

LISTINGS

ANSI/UL1598 and CAN/CSA C22.2 No. 250.0-08
Suitable for damp location
(For wet location, covered ceiling, use -WL option)

5 Year limited warranty.



Dimensions and specifications in this literature are subject to change.



0-10v Dimming Standard

LED

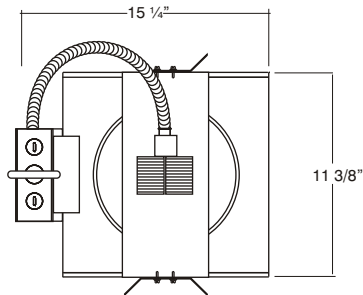
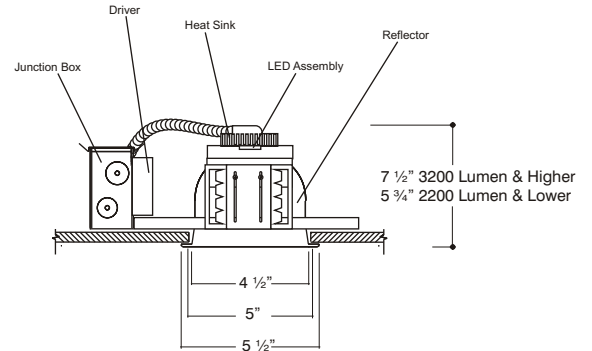

	DELIVERED LUMENS @ 35K	COLOR TEMPERATURE	CRI	REFLECTOR	REFLECTOR OPTIONS	OPTIONS	VOLTAGE		
4BLRD									
4" LED Round Recessed Downlight	-55	5488 lumens ¹	-30K	3000 K	-80	-SH Soft Haze	-RC Reg. Clear Temp. Glass Lens	-F Fusing	-120
	-42	4169 lumens ¹	-35K	3500 K	-90	-W Matte White*	-RCA Reg. Clear Acrylic Lens	-DMLV1 0-10v Dim to 1%*	-277
	-32	3217 lumens ¹	-40K	4000 K		-B Matte Black*	-RPG Reg. Prismatic Temp. Glass Lens	-DMT1 Triac Dim to 1%	Voltage MUST be Specified
	-22	2273 lumens ¹				*Powder Coat	-RPA Reg. Prismatic Acrylic Lens	-WL Wet Location (lens required)	
	-17	1686 lumens ¹					-TRW Trim Ring White	-EML1 Emergency	
	-12	1214 lumens ²					-TRB Trim Ring Black	-GTD Generator Transfer Device	
							*-12 ONLY		
							Emergency Options Use Remote Mount Test Switch		
<div style="border: 1px solid black; padding: 5px; width: fit-content; margin: 0 auto;"> <p>DECORATIVE OPTIONS ICE Suspended Clear/Etch Disk add to Trim</p> <p>-ICE Soda Lime Temp. Glass -ICE-S SOLID Soda Lime Temp. Glass -ICE-C Colorless Temp. Glass -ICE-S-C SOLID Colorless Temp. Glass</p> </div>									





4BLRD

4" LED Recessed Downlight

4BLRD-55-35K-80-SH



Test No: CRT1802201131-001 (calc)
 Source: Chip on Board
 Color Temp: 3500K
 Total Fixture Lumens: 5471
 S/MH: 1.0

Input Current
 Voltage: Watts: Amps:
 120 51 .43
 277 51 .18

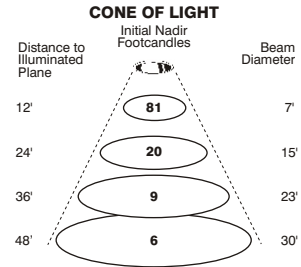
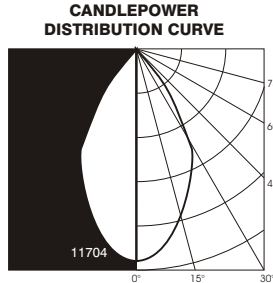

4BLRD-42-35K-80-SH



Test No: CRT1802201131-001
 Source: Chip on Board
 Color Temp: 3500K
 Total Fixture Lumens: 4157
 S/MH: 1.0

Input Current
 Voltage: Watts: Amps:
 120 49 .41
 277 49 .18

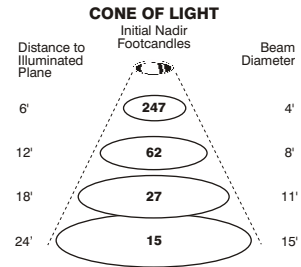
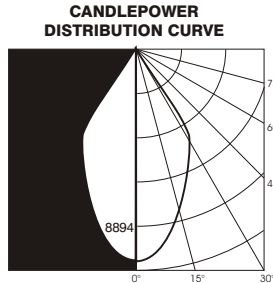

4BLRD-32-35K-80-SH



Test No: CRT1802201131-001 (calc)
 Source: Chip on Board
 Color Temp: 3500K
 Total Fixture Lumens: 3201
 S/MH: 1.0

Input Current
 Voltage: Watts: Amps:
 120 23 .19
 277 23 .08

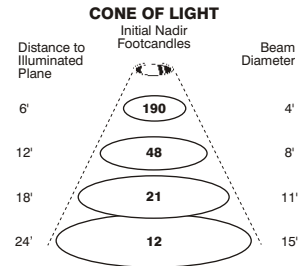
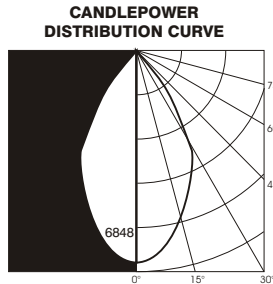

4BLRD-12-35K-80-SH



Test No: CRT1802201131-001 (calc)
 Source: Chip on Board
 Color Temp: 3500K
 Total Fixture Lumens: 1205
 S/MH: 1.0

Input Current
 Voltage: Watts: Amps:
 120 13 .11
 277 13 .05

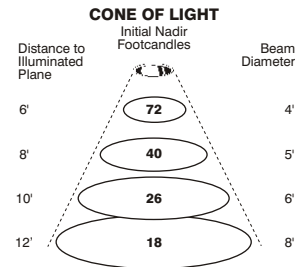
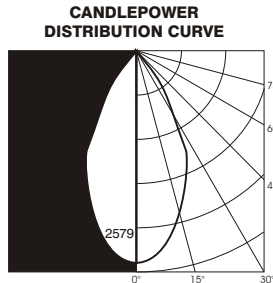

This Peachtree LED product is baseline tested at 3500K and 80+ CRI. When a warmer or cooler color temperature or 90+ CRI is specified, the light output values will vary. Use the following charts to adjust the values for your application.

CCT LUMEN CONVERSION	
3000K	4000K
.98	1.04

CRI CONVERSION	
90+	
.88	

Wattage by Lumen Package

-55 = 50.6w	-22 = 27.0w
-42 = 48.7w	-17 = 18.7w
-32 = 23.8w	-12 = 12.7w

